

05/01/19 - 3:31pm - jwade - P:\AST006-Twy A Env. & PreDesign\0400CAD\DWG\Sheets\AST006-Site.dwg

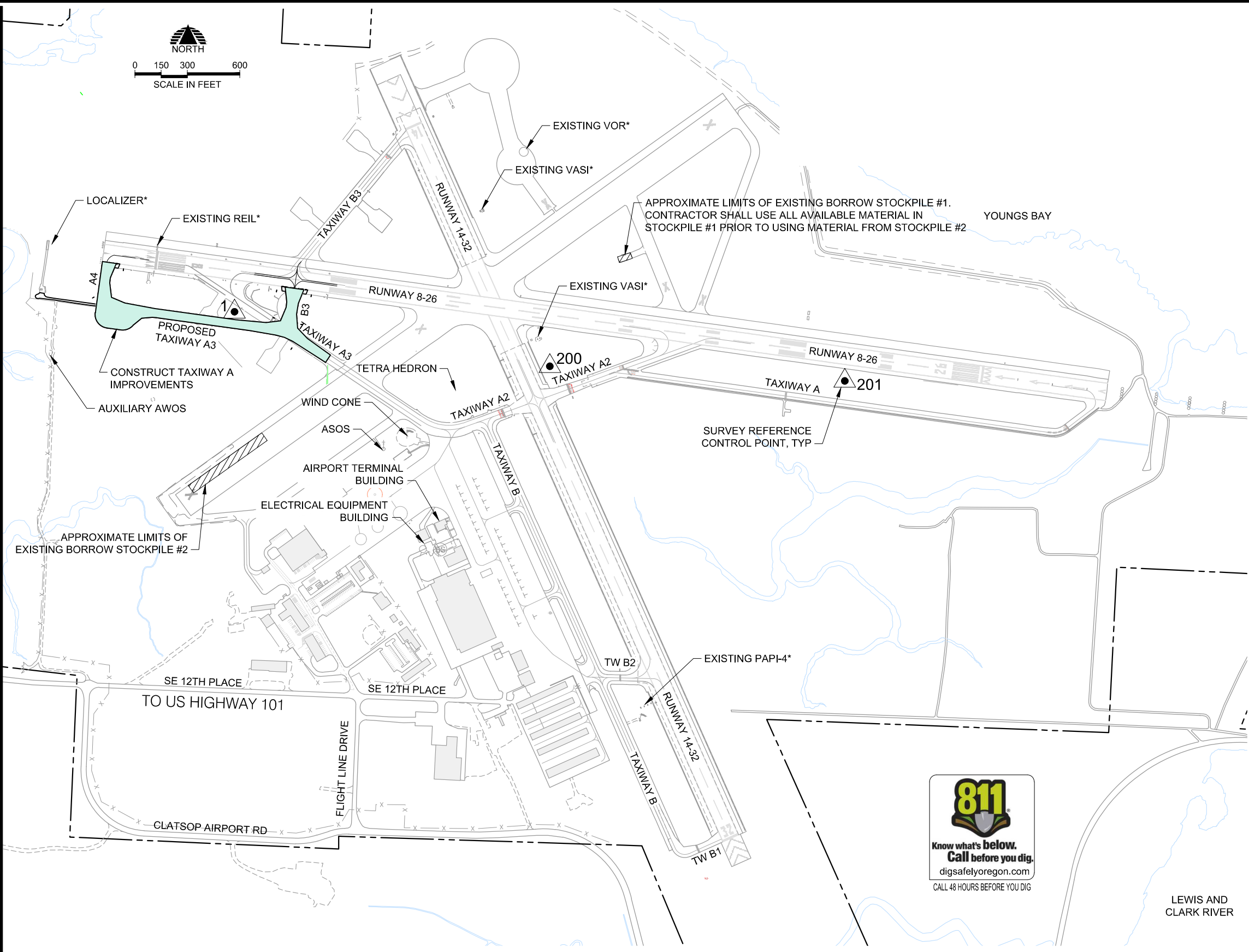

- GENERAL NOTES:**
1. THE CONTRACTOR'S ATTENTION IS DIRECTED TO THE GENERAL PROVISIONS, TECHNICAL SPECIFICATIONS AND CONSTRUCTION SAFETY AND PHASING PLAN SECTIONS OF THE CONTRACT DOCUMENT FOR REQUIREMENTS RELATING TO CONSTRUCTION SAFETY, LAYOUT WORK, QUALITY CONTROL TESTING AND OTHER CONTRACT PROVISIONS.
 2. THE CONTRACTOR SHALL BE RESPONSIBLE TO LOCATE AND PROTECT ALL UTILITIES DURING THIS PROJECT. THE CONTRACTOR SHALL BE RESPONSIBLE FOR CALLING THE UTILITY NOTIFICATION CENTER TO LOCATE PUBLIC UTILITIES AND FOR ANY AIRSIDE UTILITY LOCATES INCLUDING HIRING A PRIVATE LOCATE SERVICE AS REQUIRED. ANY UTILITIES DAMAGED IN CONJUNCTION WITH THE CONSTRUCTION ACTIVITIES SHALL BE REPLACED AND/OR REPAIRED BY THE CONTRACTOR AS APPROVED BY THE OWNER.
 3. THE FOLLOWING PERMITS HAVE BEEN OR ARE IN THE PROCESS OF BEING OBTAINED BY THE OWNER:
OREGON DEPARTMENT OF ENVIRONMENTAL QUALITY (DEQ), CONSTRUCTION STORMWATER PERMIT
OREGON DEPARTMENT OF FISH AND WILDLIFE FISH SALVAGE PERMIT
THE CONTRACTOR SHALL OBTAIN AND THE OWNER WILL PAY FOR ANY ADDITIONAL PERMITS NECESSARY TO COMPLETE THIS PROJECT.
 4. OWNER WILL OBTAIN COVERAGE UNDER THE OREGON DEPARTMENT OF ENVIRONMENTAL QUALITY CONSTRUCTION STORMWATER PERMIT. COVERAGE WILL BE TRANSFERRED TO CONTRACTOR PRIOR TO BEGINNING CONSTRUCTION. CONTRACTOR WILL ASSUME ALL RESPONSIBILITY FOR PERMIT COMPLIANCE INCLUDING BUT NOT LIMITED TO THE FOLLOWING: SUPPLY A CERTIFIED EROSION AND SEDIMENT CONTROL LEAD, SITE INSPECTION, RECORDS, REPORTING, AND TERMINATION OF COVERAGE.
 5. LIMITS OF WORK SHOWN ON THIS SHEET ARE APPROXIMATE AND SHOW GENERAL AREAS OF WORK. SEE SPECIFIC SHEETS FOR ACTUAL LIMITS OF WORK.
 6. ALL HAUL ROUTES SHALL BE MAINTAINED DURING CONSTRUCTION AND SHALL BE RESTORED TO ORIGINAL CONDITION BY THE CONTRACTOR UPON COMPLETION OF THE PROJECT. VERIFY CONDITION WITH OWNER PRIOR TO CONSTRUCTION. RESTORATION AND GRADING OF GRAVEL ACCESS ROADS SHALL BE CONDUCTED UPON COMPLETION OF USE BY THE CONTRACTOR.
 7. THE CONTRACTOR, ENGINEER, OWNER, AND OTHER INVITED REPRESENTATIVES OR GUESTS WILL CONDUCT A PRECONSTRUCTION MEETING PRIOR TO BEGINNING CONSTRUCTION IN ORDER TO DISCUSS PROJECT SCHEDULE, CONSTRUCTION REQUIREMENTS, AIRFIELD IMPACTS, AND OTHER AGENDA ITEMS RELATED TO THE PROJECT.
 8. FISH MUST BE SALVAGED FROM WORK AREA PRIOR TO THE START OF CONSTRUCTION. SEE EROSION AND SEDIMENT CONTROL PLAN FOR ADDITIONAL REQUIREMENTS.

SURVEY REFERENCE CONTROL POINTS TABLE

POINT NO.	DESCRIPTION	NORTHING	EASTING	ELEV.	REMARKS
1	AST A	926674.961	7344059.688	10.03	PAC
200	AST ARP 2	926364.138	7345865.181	11.51	SAC
201	AST AP 1963	926281.171	7347552.650	11.0	SAC

HORIZONTAL DATUM: NAD 83 OREGON STATE PLANE NORTH ZONE
COORDINATES SHOWN ARE INTERNATIONAL FEET
VERTICAL DATUM: NAVD 88

- SURVEY NOTES:**
1. HORIZONTAL AND VERTICAL CONTROL SURVEY REFERENCE POINTS ARE PROVIDED FOR CONTROL OF THE PROJECT. ALL LAYOUT AND CONSTRUCTION SURVEYING SHALL BE CONDUCTED BY A PROFESSIONAL LAND SURVEYOR REGISTERED IN THE STATE OF OREGON.
 2. PRIOR TO BEGINNING ANY LAYOUT, THE CONTRACTOR'S SURVEYOR SHALL OCCUPY ALL REFERENCE CONTROL POINTS SHOWN IN THE TABLE ON THIS SHEET AND VERIFY DATA GIVEN. ANY DISCREPANCY SHALL IMMEDIATELY BE BROUGHT TO THE ENGINEER'S ATTENTION FOR CLARIFICATION OR CORRECTION. NOTES SHOWING CONFIRMATION OF THE HORIZONTAL AND VERTICAL IN ACCORDANCE WITH GENERAL PROVISION SECTION 50-06 SHALL BE PROVIDED TO THE ENGINEER PRIOR TO STARTING CONSTRUCTION.

* FAA OWNED EQUIPMENT

NOTE:
THIS DRAWING IS INTENDED TO BE PRINTED IN COLOR.
PRINTING IN BLACK AND WHITE MAY REDUCE READABILITY
AND ALTER ENTITY DEFINITION OR REPRESENTATION.

PRECISION APPROACH
ENGINEERING
5125 Southwest Hout Street
Corvallis, OR 97333
541•754•0043

REGISTERED PROFESSIONAL ENGINEER
72093916
DIGITALLY SIGNED
OREGON
JUNE 14, 2019
GEOFF W. VAUGHN
EXPIRES 6/30/2020

REVISIONS:	DATE	APPD.

DATE:	MAY 2019
DESIGN:	DRR
DRAWN:	JAW
CHECKED:	GWV
REVISION NUMBER:	0
SCALE:	AS SHOWN

PORT OF ASTORIA REGIONAL AIRPORT
TAXIWAY A WEST IMPROVEMENTS

SITE PLAN

PRECISION APPROACH ENGINEERING, INC.
AIP NO. 3-41-0003-024-2019

PROJECT NUMBER:
AST006

SHEET NO.
4

OF **38**